

8th Grade Day for Strings Map
Students: Keep this map with you

NORTH FARMINGTON HIGH SCHOOL

Cellos and Bases

Drop-off and enter HERE →

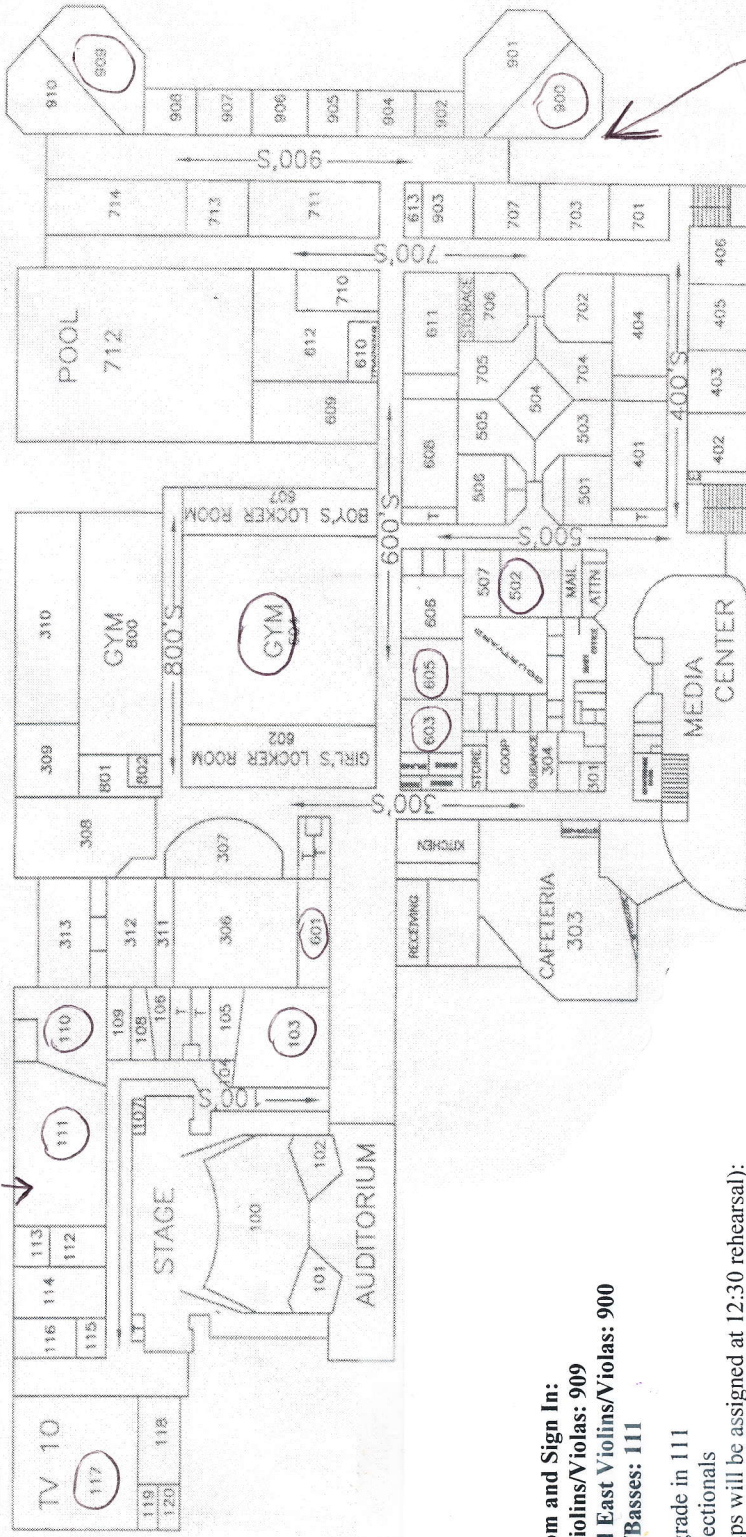

Drop-off and enter HERE →
Violas and Violas

PARKING

- 12:10PM: Coat Room and Sign In:**
- Warner Violas/Violas: 909**
- Power and East Violas/Violas: 900**
- All Cellos/Bases: 111**
- 12:30 PM: ALL 8th grade in 111**
- 1:30 PM: 8th grade sectionals**
 (violin and cello groups will be assigned at 12:30 rehearsal):
 Violin group A: 601 (Dance Studio)
 Violin group B: 605
 Violin group C: 117 (TV 10 Studio)
 Violin group D: 502
 Violas: 603
 Cello group A: 111 (same as orchestra rehearsal)
 Cello group B: 103 (Choir room)
 Bass: 110 (Percussion room)
- 2:30 PM: ALL 8th grade in 111**
- 3:30 PM: Concert in Gym**

----- **13 Mile Road** ----- school entrance